



Request for Qualifications

University of Nebraska Lincoln | College of Engineering



RFQ Submission Deadline: March 27, 2022

Total Budget: \$400,000



Project Description

UNL is home to the sole College of Engineering in the state of Nebraska, supplying engineering education and leadership in technology-based economic development for the state, the nation and the world. The College of Engineering offers the state's only nationally accredited undergraduate degree programs, as well as 13 master's programs and 11 doctoral programs. This is a major project to expand and renovate the College of Engineering complex and create a large green space and pedestrian walk way.

Slated to open in 2023, the \$115 million Kiewit Hall will serve as the academic hub for undergraduate engineering education and house Lincoln-based construction management programs; including classrooms, instructional labs, Engineering Student Services, maker spaces for the college's student organizations, and a large outdoor plaza for the university community. Scott Engineering Center is also being renovated, and will feature enhanced spaces for research labs, graduate students, and several academic departments.

What was once used for car traffic, 17th street will be transformed into a green space and the site for this artwork project. The green space will be surrounded by the expanded engineering complex. The Kiewit Hall will connect to Othmer Hall via a skyway, and expanding the complex that includes Scott Engineering Center, the Link, and Nebraska Hall. Connected on the west side of the green space, there are student residence halls and food services.

Most recently, in partnership with senior executives and University of Nebraska alumni at Kiewit Corporation, we have created the [Kiewit Scholars Program](#) - a full-tuition scholarship combined with a rigorous leadership program that will support 40 undergraduate students. This program is unparalleled among our Big Ten and other top-ranking colleges of engineering.

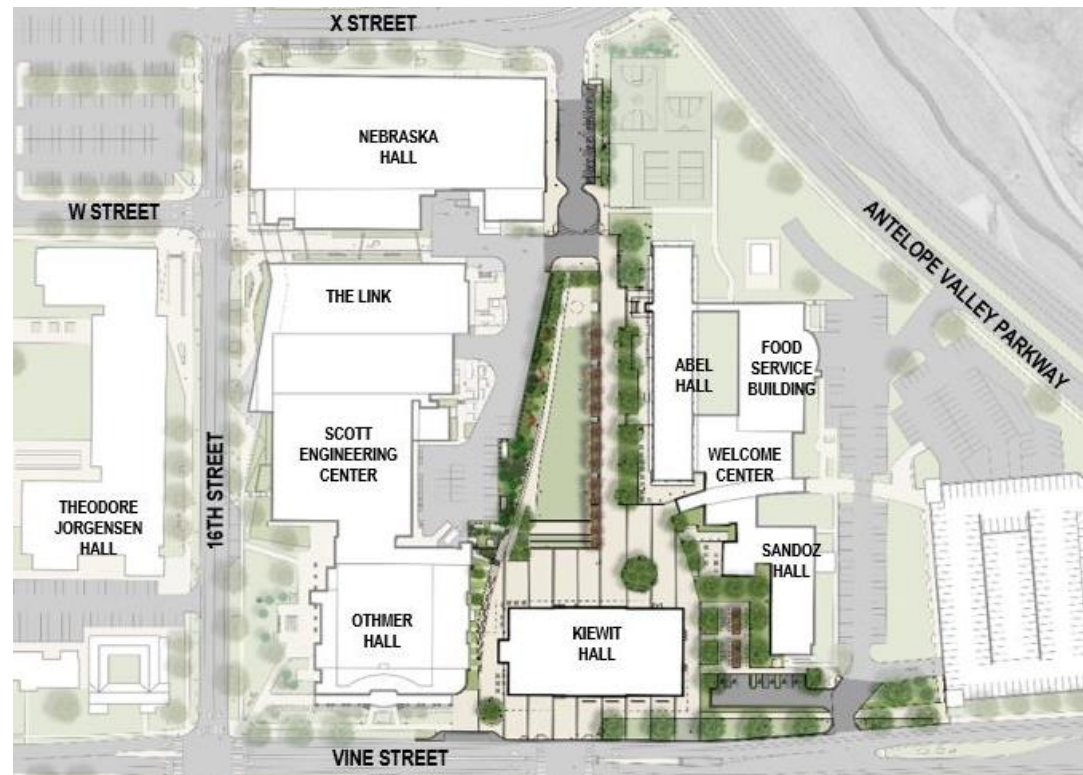



Site and Artwork Overview

The UNL Engineering complex is undergoing major renovations and construction. The new lawn at the crux of the complex activity is intended to create a more pedestrian and linger-friendly lawn space within what used to be a road. This project is to place a large, permanent sculpture at the central focal point on the complex, that reflects or inspires the innovations of the programs surrounding it.

The goal for this artwork is to be both eye-catching and inviting, and to encourage people to linger and use the space – so the artwork should be interesting to view both at a distance and close-up. The Committee uses words like dynamic, interactive, relatable, and envisions something bold, with significant and possibly vertical presence. The Committee would like to avoid figural work, campus or other generic branding, and work that sits at the height of a pole to achieve height. The sculpture must be engineered and designed with materials that can withstand Nebraska weather and wind.

The site itself is located towards one end of the lawn. The artwork should be contained within the space allotted for it on the map, which is laid out in a map on the following page. For more renderings and site information: <https://engineering.unl.edu/construction-central/>

UNL has an incredible collection of sculptures spread throughout the City Campus: <https://publicart.artscene.org/location/unl-city-campus/>



Some of the nearby public artwork on campus: “*Breach*” by Roxy Paine, “*Torn Notebook*” by Claes Oldenburg, “*Greenpoint*” by Richard Serra.

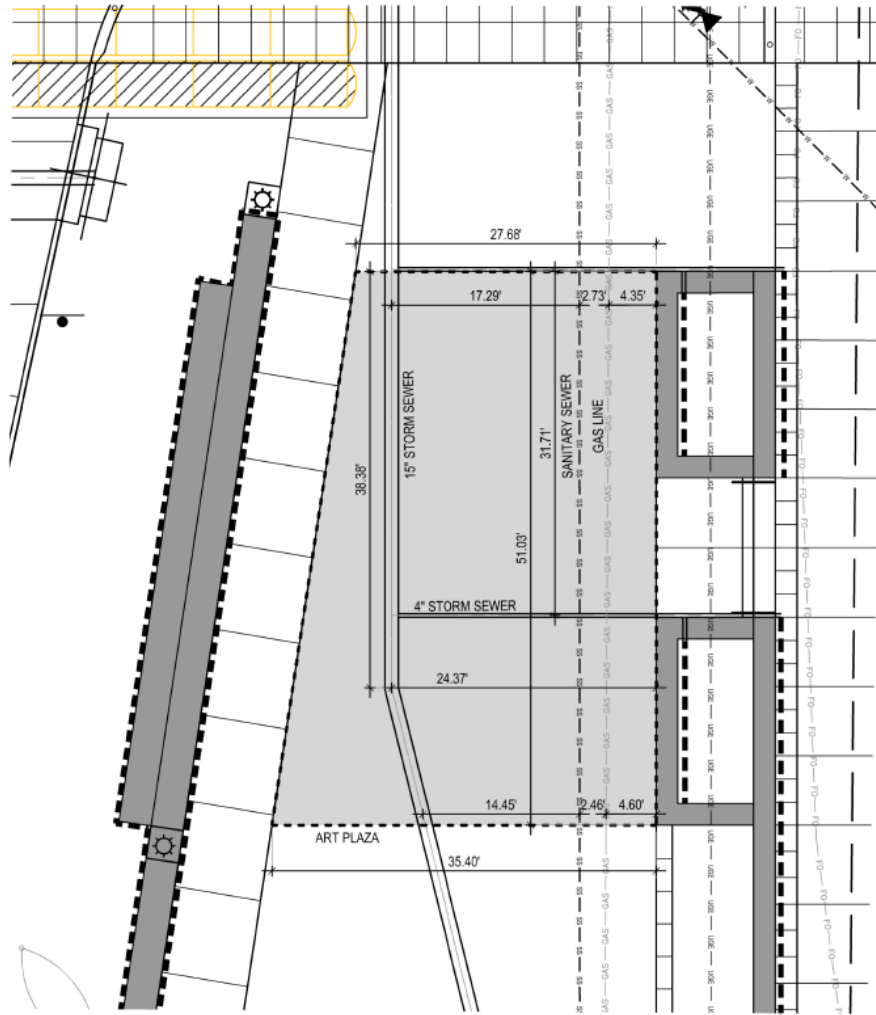

N **SITE PLAN: ART PLAZA**
SCALE: 1"=10'-0"

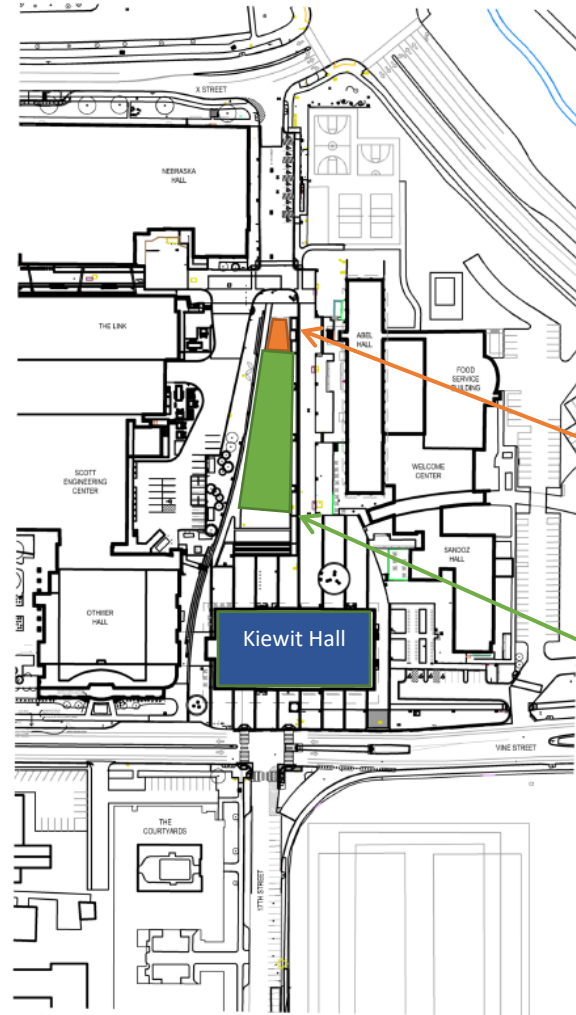

N **OVERVIEW PLAN**
SCALE: NTS

CLARK & ENERSEN

Architecture \ Engineering \
Interior Design \ Planning \
Landscape Architecture

clarkenersen.com
Lincoln, Nebraska
1010 Lincoln Mall, Suite 200
Lincoln, NE 68508-2883
P: 402.477.9291 F: 402.477.6542

Kansas City, Missouri
Fairway, Kansas
Portland, Oregon
Fort Collins, Colorado

Art Plaza,
location for
sculpture

Lawn space,
with trees

College of Engineering
Phase 1 Art Plaza
Lincoln, Nebraska
CE No.: 018-272-20

Art Plaza Exhibit
Date: Nov 18, 2021



Selection Process

The COE Phase 1 Art Selection Committee, in consultation with the NAC, has full oversight for the selection of an artist for this project. Professional public artists/teams within the U.S. are eligible. The committee reviews RFQ submissions on SlideRoom.

Finalists will receive a presentation honorarium and a travel stipend, if applicable. Finalist presentations should include concept, design, detailed budget for the available funds, installation method, projected maintenance.

Budget

A maximum of \$400,000.00 is allocated for this project. All expenses for the selected design and commission are the responsibility of the artist/team, including but not limited to: travel/lodging, fabrication and supplies, installation expenses (as needed: lighting, engineering, footings, rigging, equipment rental, etc)

Selection Criteria

Clarity of conceptual approach for work in Letter of Interest and in artwork descriptions. Evidence of ability to complete projects from prior artwork samples.

Timeline *subject to change.

RFQ Open:	Jan. 16, 2022
Submission Deadline:	March 27, 2022
Finalists Notified:	April 8, 2022
Proposal Presentations:	July 2022
Artwork Installed:	July-Aug 2023

Application Requirements

Submit materials on SlideRoom: nebraska.slideroom.com

Visual Support Materials

Image descriptions: Label each uploaded image: project budget, title, materials, size, years in progress and year completed, location of installed work, collaborators, and other relevant description.

Images: Ten (10) jpg images of completed relevant artworks.

Video: Optional video file may demonstrate moving parts, time-based work, functionality, etc. (mov, wmv, or flv files, no larger than 60MB each, nor longer than five minutes each.)

Required Materials

Letter of Interest: Briefly describe how you intend to use the site; describe your artistic style, background, and relevant past completed projects, and they relate to this project. Use 500 words or less.

CV/Resume: Outline your professional accomplishments as an artist, including exhibition history, site-specific commissions, and public collections. Limit to three pages.

Three Professional References: Complete contact information for references with a deep knowledge artwork and work methods, and for which project they worked with you.

Application Fee: \$10 via the secure payment system on SlideRoom.

Contact

Meagan Dion, Public Art and Artist Programs Specialist
Nebraska Arts Council, meagan.dion@nebraska.gov